

INSTALLATION

3

Assembly the frame and plinth by 8 sets M6-12 screws and M6 flange nuts.

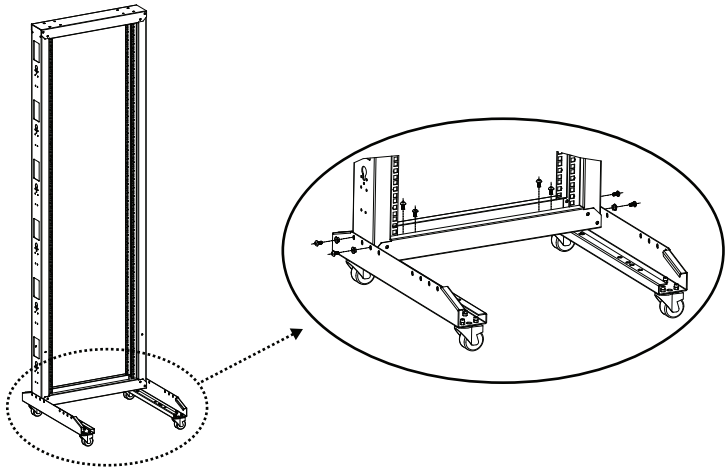
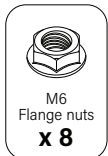

After assembly, please adjust the diagonal size of the cabinet to ensure homogeneous space for all doors and all doors work well.

ACCESSORIES

Standard Rack Shelf

- SRS-1U-10
- SRS-1U-10V
- SRS-1U-15
- SRS-1U-15V
- SRS-2U-10
- SRS-2U-10V
- SRS-2U-15
- SRS-2U-15V

Vertical Cable Manager

- VCM-2-22U
- VCM-2-32U
- VCM-2-42U

Drawer with Lock

- DWL-1U
- DWL-2U
- DWL-3U
- DWL-4U

Rack Mounting Hardware

- RMH-1032-K
- RMH-1032-C
- RMH-1032-S
- RMH-1224-K
- RMH-M6-K
- RMH-1224-S

Cable Management Solutions

- CMS-1-PC
- CMS-1-MH
- CMS-1-MC
- CMS-1-PR
- CMS-2-PC
- CMS-2-MH
- CMS-2-MC
- CMS-2-PR
- CMS-1-BRS
- LB-0-D
- LB-2-D
- LB-4-D
- LB-6-D
- CNT-1

MAINFRAME 2-POST OPEN FRAME RACK SERIES

OFDR-2-22/32/42U

ASSEMBLY INSTRUCTION

V. 1.1

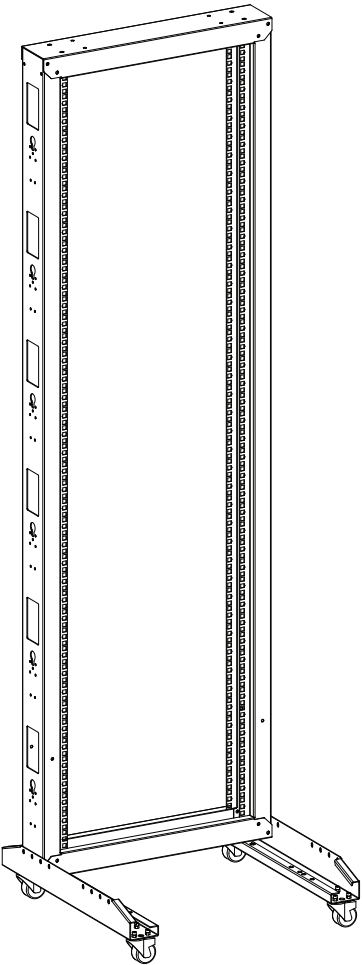

ITEM LIST

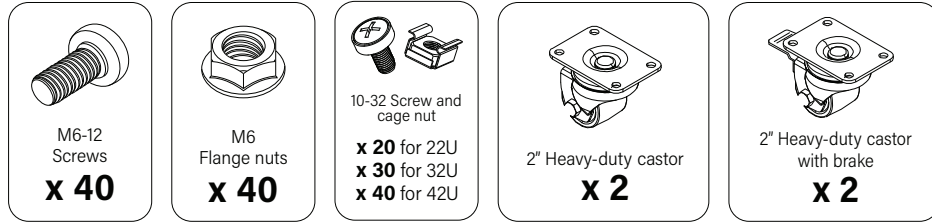

Check the quantities of the items before assembly.

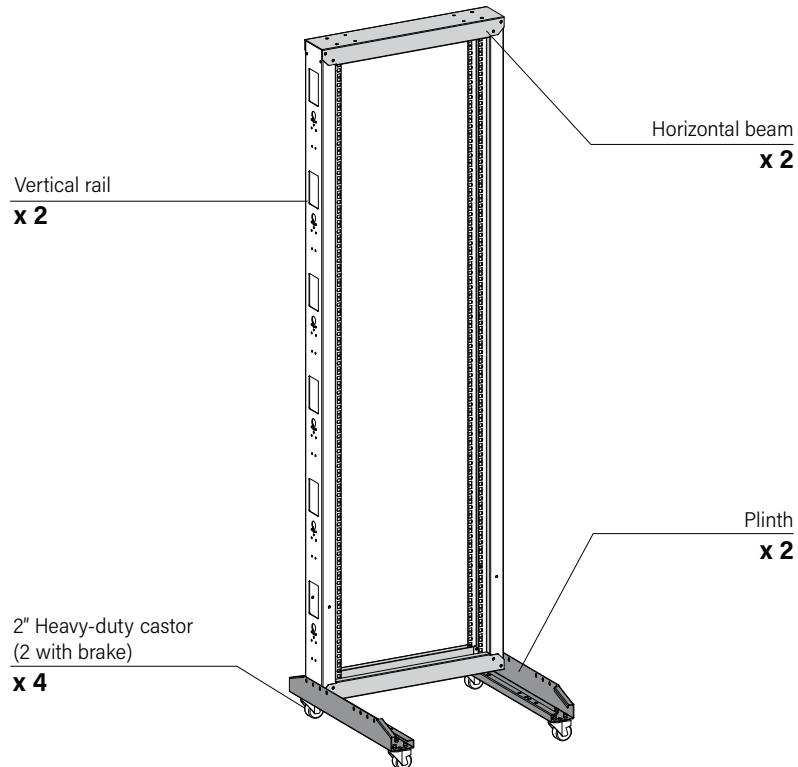

INSTALLATION

1

Assembly vertical rails and horizontal beams to form the frame with 16 sets M6*12 screws and M6 flange nuts.

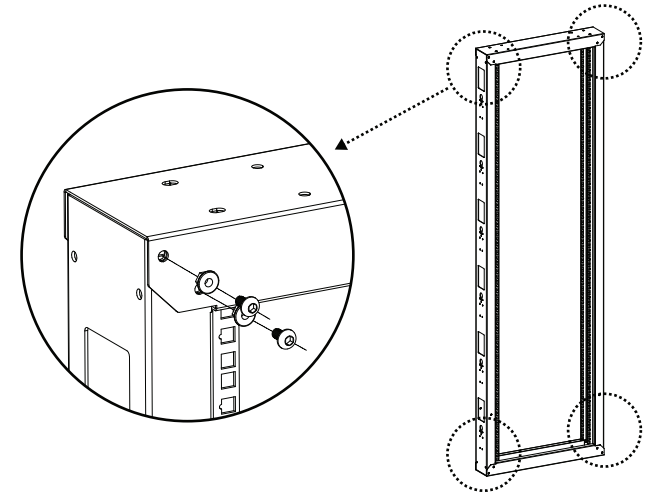

2

Assembly the castors on the Plinths by 16 sets M6*12 screws and M6 flange nuts.

